

Reflex level gauge glass

Reflex level gauge glasses offered by us are made by a recognized, global companies like Klinger, Maxos, Spectraglass of high-quality borosilicate ("extra hard") or aluminosilicate glasses. Glass in the production process is subjected to a polishing and toughening. This results in products characterized by high mechanical strength and high resistance to alkalis, acids and condensates. In the production process is conducted constant and precise control of transparency and the dimensions of manufactured glass.

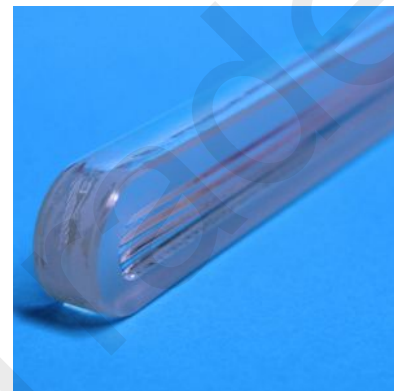

Reflex gauge glasses are used to read the liquid level directly or with the use of CCTV (industrial television). In this type of glass on the chamber side (medium side) are imprinted longitudinal grooves (3 or 4), which walls are angled to each other at an angle of 90°. Squeezing process causes the formation of grooves. On the surface of the grooves creates extremely smooth and hard glass layer, very resistant to the environment. With the grooving increases the angle of refraction which makes the visibility of the liquid level is much better than when using smooth glass. **For reflective glass does not apply mica shields.**

Reflex glasses may be used in pressure up to 35 bar. In this area are sufficiently resistant to the environment. The reading is clear and contrast. In the case of factors other than steam reflex glasses may be used up to 400 bar or 400°C

Depending on the width and thickness there are four basic types of reflex level gauge glasses:

type A - width 30 mm, thickness 17 mm

type B - width 34 mm, thickness 17 mm

type H - width 34 mm, thickness 22 mm

In addition, the occasionally encountered also:

- **type C** - width of 20 mm, thickness 12 mm
- **type D** - width 25 mm, thickness 15 mm

Scope of application:

	Type A		Type B		Type H	
	[bar]	[°C]	[bar]	[°C]	[bar]	[°C]
For soft environment, not affecting aggressive on the glass ie. oils, hydrocarbons, etc.	400	120	265	120	300	120
	150	400	180	400	200	400
	0 - 10	430	0 - 10	430	0 - 10	430
For aggressive environment acting on the glass, eg. saturated steam, hot water, alkalis	35	243	35	243	42	253

Reflex level gauge glass meets the conditions of the following standards:

- ÖNORM M 7354 (Austrian standard)
- **DIN 7081 (German standard)**
- JIS B 8211 (Japanese standard)
- ÖMV-Spez. H 2009 (Austrian factory standard of the petrochemical concern ÖMV-AG, Vienna)
- MIL-G-16356 D (regulations the US Navy)
- Esso Eng. Spec. 123 (Esso Research & Engineering Co. - New Jersey)
- S.O.D. Spec. 123 (Standard Oil Development Company - New Jersey)
- BS 3463 (British Standard)

Dimensions

Size	TYPE A			TYPE B			TYPE H		
	L	W	H	L	W	H	L	W	H
0	95	30	17	95	34	17	-	-	-
I	115	30	17	115	34	17	115	34	22
II	140	30	17	140	34	17	140	34	22
III	165	30	17	165	34	17	165	34	22
IV	190	30	17	190	34	17	190	34	22
V	220	30	17	220	34	17	220	34	22
VI	250	30	17	250	34	17	250	34	22
VII	280	30	17	280	34	17	280	34	22
VIII	320	30	17	320	34	17	320	34	22
IX	340	30	17	340	34	17	340	34	22
X	-	-	-	370	34	17	-	-	-

All dimensions in mm.

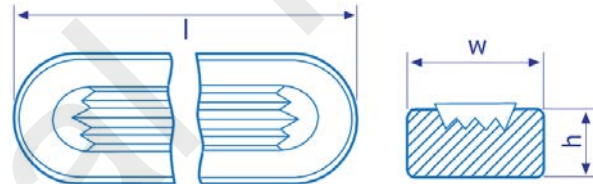

Reflex level gauge glasses are supplied in **sets** with gaskets or **separately**.

The set includes:

- borosilicate reflex glass
- gasket C4400
- graphite gasket

We also provide glass unusual: manufactured according to individual customer technical requirements, custom sizes and custom shapes.