

### APPLICATION:

Observation and illumination of the interior of closed vessels (boilers, tanks, silos, etc.). Sightglasses are round flange sockets for welding into or onto the vessel, each complete with a firmly screwed sightglass plate inserted between the gaskets.

The sizes DN300 and DN400 are particularly suitable for [biogas applications](#).

### INSTALLATION NOTE:

After welding the base flange onto/into the pressure vessel, the sealing surface must be checked for deformations! Reworking may be required! Observe the listed torque values for remounting the cover flange! The pressure rating does not consider the base flange. This will have to be audited together with the pressure vessel according to AD 2000 instructions B9 or equivalent standard!

Similar to DIN 28120  
Lightweight design  
( $\Delta P \leq 2.5$  bar)

### Operating conditions:

Temperature: (depending on glass and gasket)	150 °C 280 °C 400 °C <sup>1</sup>
Pressure:	≤2,5 Bar

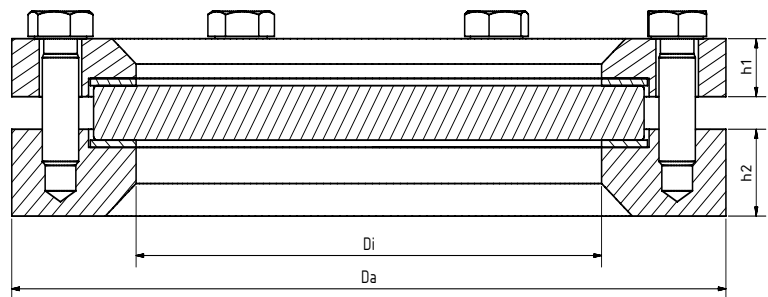

### Materials:

Flange:	1.4571
Glass:	Borosilicate glass DIN 7080 Soda-lime glass DIN 8902 Borosilicate glass untempered
Gasket:	PTFE; FKM; NBR; C4400; Silicone; EPDM; Graphite
Screws:	A4-70
Special materials on request	

DN	50	80	100	125	150	200	300	400
Da	150	175	200	220	250	300	370	450
Di	80	100	125	150	175	225	300	370
h1	12	14	14	16	16	16	20	20
h2	24	24	24	24	24	24	24	24
kg	3,8	5,2	6,1	7,2	8,9	11,5	15,1	21,3
Nm	37 <sup>2</sup>	52 <sup>2</sup>	63 <sup>2</sup>	44 <sup>2</sup>	48 <sup>2</sup>	55 <sup>2</sup>	42 <sup>2</sup>	30 <sup>2</sup>

<sup>1</sup> high temperature on request <sup>2</sup> graphite gasket



# Round sight glass fitting PN 2.5

Welding in or on similar to DIN 28120

# Type 318

## PRODUCTCODE:

Group	TYPE	DN	Base flange*	Glass	Gasket	Variant
11	318	50 80 100 125 150 200 300 400	1: 1.4571 2: P265GH	1: Borosilicate glass (Boro) DIN 7080 2: Soda lime glass (SLG) DIN 8902 3: Quartz glass 4: Boro + PTFE wiper 5: Boro + silicone wiper 6: SLG + PTFE wiper 7: SLG + silicone wiper 8: Borosilicate glass untempered	1: PTFE 2: FKM 3: NBR 4: C4400 5: Silicone 6: EPDM 7: Graphite 8: Special	G00: Boro with Mica shield (up to 320°C) S00: spraying device Assigned by ACI if required

**INFO:** Unless otherwise stated, the factory standard highlighted is supplied.

\*Cover flange according to quotation / order confirmation.

## SPECIAL DESIGNS/OPTIONS:

- Wiper SWI with PTFE or silicone Wiper blade
- LED or halogen lights, ATEX-certified, EX
- High-temperature version with quartz glass or untempered Boro up to 400°C, higher on request
- Spray device SVI
- FEP protective screen

## EXAMPLE:

**11-318-100-1-1-7-000** equals the product code:

ACI Type 318  
DN100  
Base flange 1.4571  
borosilicate glass  
gasket graphite  
standard version



## RECOMMENDATION:

For aggressive media or steam, mica discs should be used to protect the glass.

Kontakt w Niemczech  
ACI Industriearmaturen GmbH  
Tel. +49 (0) 2403 748 850  
info@aci24.com • www.aci24.com

Kontakt w Polsce:  
Continental Trade Sp. z o.o.  
tel. +48 22 670 11 81  
office@continentaltrade.com.pl  
http://continentaltrade.com.pl

20200210

Technical changes and errors reserved!